

**AMENDMENT NO. 80 TO BOUNDARIES OF CITY OF MORENO VALLEY
COMMUNITY FACILITIES DISTRICT NO. 2014-01 (MAINTENANCE SERVICES)**

**CITY OF MORENO VALLEY
COUNTY OF RIVERSIDE
STATE OF CALIFORNIA**

(THIS MAP AMENDS, BY ADDING THE ADDITIONAL TERRITORY SHOWN HEREON, THE
BOUNDARY MAP FOR CITY OF MORENO VALLEY COMMUNITY FACILITIES DISTRICT NO.
2014-01 (MAINTENANCE SERVICES), CITY OF MORENO VALLEY, RIVERSIDE COUNTY, STATE
OF CALIFORNIA, PRIOR RECORDED AT BOOK 76 OF MAPS OF ASSESSMENT AND
COMMUNITY FACILITIES DISTRICTS AT PAGE 69. IN THE OFFICE OF THE COUNTY
RECORDER FOR THE COUNTY OF RIVERSIDE, STATE OF CALIFORNIA.)

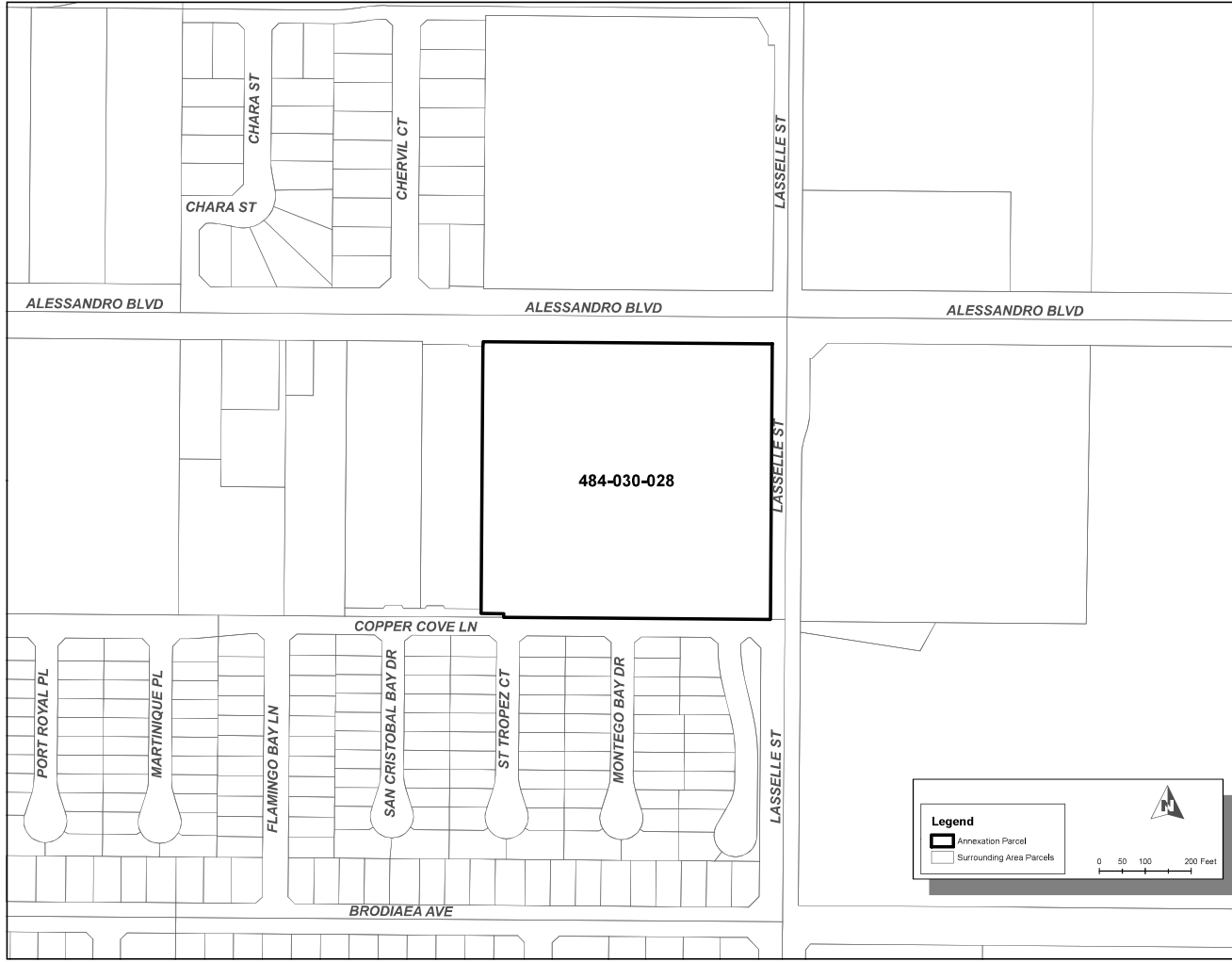

FILED IN THE OFFICE OF THE CITY CLERK OF THE CITY OF MORENO VALLEY THIS _____ DAY
OF _____, 20__.

CITY CLERK
CITY OF MORENO VALLEY

I HEREBY CERTIFY THAT THE WITHIN MAP SHOWING AMENDED BOUNDARIES OF CITY OF MORENO VALLEY
COMMUNITY FACILITIES DISTRICT NO. 2014-01 (MAINTENANCE SERVICES), CITY OF MORENO VALLEY,
COUNTY OF RIVERSIDE, STATE OF CALIFORNIA, WAS APPROVED BY THE CITY COUNCIL OF THE CITY OF
MORENO VALLEY, AT A REGULAR MEETING THEREOF, HELD ON THE _____ DAY OF _____, 20__
BY ITS RESOLUTION NO. _____.

CITY CLERK
CITY OF MORENO VALLEY

FILED THIS _____ DAY OF _____, 20__ AT THE HOUR OF _____ O'CLOCK _____ M. IN THE
BOOK _____ PAGE(S) _____ OF MAPS OF ASSESSMENTS AND COMMUNITY FACILITIES DISTRICTS AND
INSTRUMENT NO. _____ IN THE OFFICE OF THE COUNTY RECORDER OF THE
COUNTY OF RIVERSIDE, STATE OF CALIFORNIA.

COUNTY RECORDER
COUNTY OF RIVERSIDE
STATE OF CALIFORNIA

REFERENCE IS MADE TO THAT BOUNDARY MAP OF THE COMMUNITY FACILITIES DISTRICT NO. 2014-01
(MAINTENANCE SERVICES) OF THE CITY OF MORENO VALLEY RECORDED WITH THE RIVERSIDE COUNTY
RECORDER'S OFFICE ON FEBRUARY 20, 2014 IN BOOK 76 OF MAPS OF ASSESSMENTS AND COMMUNITY
FACILITIES DISTRICTS, PAGE 69 AS INSTRUMENT NO. 2014-0066114.

REFERENCE IS FURTHER MADE TO ANNEXATION MAP NO. 3 OF COMMUNITY FACILITIES DISTRICT NO. 2014-
01 (MAINTENANCE SERVICES) OF THE CITY OF MORENO VALLEY, COUNTY OF RIVERSIDE, CALIFORNIA
(TERRITORY PROPOSED FOR ANNEXATION IN THE FUTURE, WITH THE CONDITION THAT PARCELS WITHIN
THE TERRITORY MAY BE ANNEXED ONLY WITH THE UNANIMOUS APPROVAL OF THE OWNER OR OWNERS
OF EACH PARCEL OR PARCELS AT THE TIME THAT PARCEL OR THOSE PARCELS ARE ANNEXED) RECORDED
WITH THE RIVERSIDE COUNTY RECORDER'S OFFICE ON MARCH 9, 2021 IN BOOK 86, PAGE 45 OF MAPS OF
ASSESSMENTS AND COMMUNITY FACILITIES DISTRICTS AS INSTRUMENT NO. 2021-0149686, WHICH
DESIGNATED THE TERRITORY SHOWN HEREIN AS TERRITORY FOR FUTURE ANNEXATION TO THE
COMMUNITY FACILITIES DISTRICT REFERENCED THEREON.

THE LINES AND DIMENSIONS OF EACH LOT OR PARCEL SHOWN ON THIS DIAGRAM SHALL BE THOSE LINES
AND DIMENSIONS AS SHOWN ON THE RIVERSIDE COUNTY ASSESSOR'S MAPS FOR THOSE PARCELS
LISTED.

THE RIVERSIDE COUNTY ASSESSOR'S MAPS SHALL GOVERN FOR ALL DETAILS CONCERNING THE LINES
AND DIMENSIONS OF SUCH LOTS OR PARCELS.

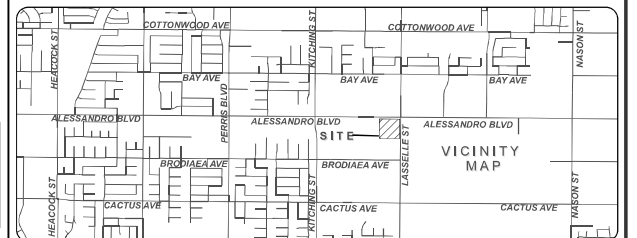
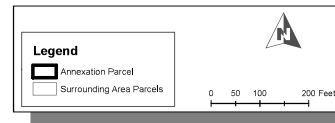

Source: Riverside County GIS
Geographic Coordinate Reference: GCS North American 1983
Projection: NAD 1983 StatePlane California VI FIPS 0406 Feet

